

3/4"-14NPT
Male Threads
Both Ends

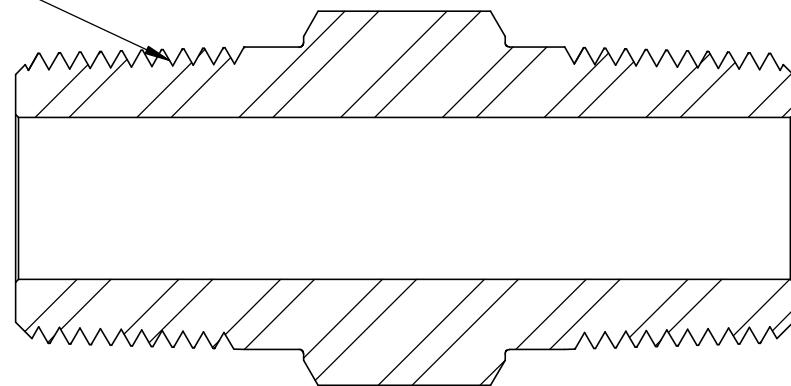

SECTION D-D

REVISION NOTES AND DATES

UNLESS OTHERWISE SPECIFIED:

- 1) DIMENSIONS ARE IN INCHES
- 2) TOLERANCES:
FRACTIONAL $\pm 1/64"$
ANGULAR: MACH $\pm 2^\circ$
ONE PLACE DECIMAL $\pm .020$
TWO PLACE DECIMAL $\pm .010$
THREE PLACE DECIMAL $\pm .005$
- 3) THREADS UNIFIED CLASS
2A - 2B
- 4) SURFACE FINISH 63 μ in Ra
- 5) CHAMFER THREADS:
MALE - 30° TO ROOT
FEMALE - 45° TO ROOT

	NAME	DATE
DRAWN	MH	7/18/2013
CHECKED	KH	06/10/2022
DATE STARTED IN PRODUCTION:		
06/10/2022		

**ULTRA PRESSURE COMPONENTS
HOUSTON, TX**

TITLE:
3/4" NPT Male x 3/4" NPT Male
10,000 psi

SIZE	DWG. NO.	REV
A	5404-12N12N	Y

SCALE: 1.5:1 WEIGHT: 0.47 SHEET 1 OF 1



PROPRIETARY AND CONFIDENTIAL
THE INFORMATION CONTAINED IN THIS DRAWING IS THE SOLE PROPERTY OF ULTRA PRESSURE COMPONENTS. ANY REPRODUCTION IN PART OR AS A WHOLE WITHOUT THE WRITTEN PERMISSION OF ULTRA PRESSURE COMPONENTS IS PROHIBITED.