

1"-11.5NPT
Male Connection
Both Ends

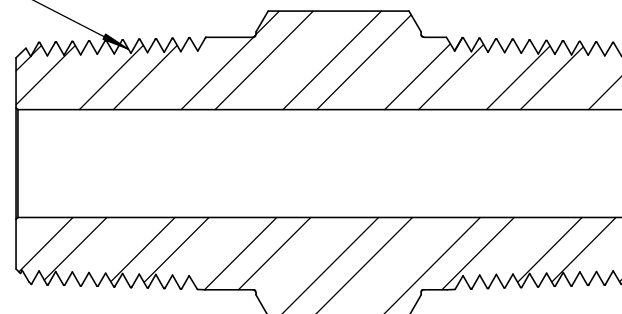

SECTION A-A

REVISION NOTES AND DATES

UNLESS OTHERWISE SPECIFIED:

ALL DIMENSIONS ARE IN INCHES
TOLERANCES AS FOLLOWS:
1 PLACE DECIMAL (.0): ± 0.030
2 PLACE DECIMAL (.00): ± 0.020
3 PLACE DECIMAL (.000): ± 0.010
ANGLES: $\pm 2^\circ$

SURFACE FINISH: 63RMS
BREAK ALL EDGES: .010-.015
FILLETS & ROUNDS: R.015 - 0.30

THREADS UNIFIED CLASS 2A - 2B
CHAMFER THREADS 45° TO ROOT
30° CHAMFER IS OPTIONAL
FOR MALE THREADS ONLY

	NAME	DATE
DRAWN	MH	06/16/2022
CHECKED	KH	06/16/2022

DATE STARTED IN PRODUCTION:

06/16/2022



**ULTRA PRESSURE COMPONENTS
HOUSTON, TX**

TITLE:

1" NPT Male x 1" NPT Male
10,000 psi

SIZE A	DWG. NO. 5404-16N16N	REV Y
SCALE: 1:1	WEIGHT: 0.99	SHEET 1 OF 1

PROPRIETARY AND CONFIDENTIAL

THE INFORMATION CONTAINED IN THIS DRAWING IS THE SOLE PROPERTY OF ULTRA PRESSURE COMPONENTS. ANY REPRODUCTION IN PART OR AS A WHOLE WITHOUT THE WRITTEN PERMISSION OF ULTRA PRESSURE COMPONENTS IS PROHIBITED.