

1"-11.5 NPT  
Male Thread

3/8" BSP  
Male Thread

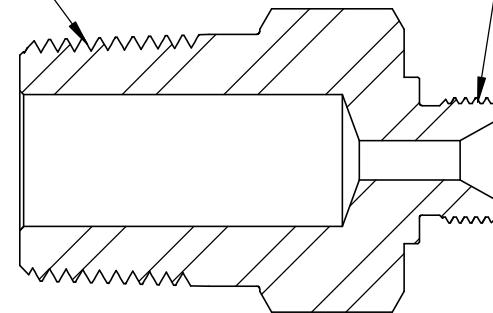

SECTION A-A

UNLESS OTHERWISE SPECIFIED:

ALL DIMENSIONS ARE IN INCHES  
TOLERANCES AS FOLLOWS:

1 PLACE DECIMAL (.0): ±.020  
2 PLACE DECIMAL (.00): ±.010  
3 PLACE DECIMAL (.000): ±.005  
ANGLES: ±2°

SURFACE FINISH: 63RMS  
BREAK ALL EDGES: .010-.015  
FILLETS & ROUNDINGS: R.015 - 0.30

THREADS UNIFIED CLASS 2A - 2B  
CHAMFER THREADS 45° TO ROOT  
30° CHAMFER IS OPTIONAL  
FOR MALE THREADS ONLY

	NAME	DATE
DRAWN	BM	1/25/2023
CHECKED	KH	01/20/2023
DATE STARTED IN PRODUCTION:		
01/20/2023		



We can handle Pressure

**ULTRA PRESSURE COMPONENTS  
HOUSTON, TX**

TITLE:

1" NPT MALE X 3/8" BSP MALE  
MAWP 10,000 PSI

SIZE	DWG. NO.	REV
<b>A</b>	5404-16N6B	<b>Y</b>

SCALE: 1:1	WEIGHT: 0.65	SHEET 1 OF 1
------------	--------------	--------------

REVISION NOTES AND DATES

**PROPRIETARY AND CONFIDENTIAL**

THE INFORMATION CONTAINED IN THIS DRAWING IS THE SOLE PROPERTY OF ULTRA PRESSURE COMPONENTS. ANY REPRODUCTION IN PART OR AS A WHOLE WITHOUT THE WRITTEN PERMISSION OF ULTRA PRESSURE COMPONENTS IS PROHIBITED.